



US010098339B2

(12) **United States Patent**
Pinkston

(10) **Patent No.:** **US 10,098,339 B2**

(45) **Date of Patent:** ***Oct. 16, 2018**

(54) **SYSTEMS AND METHODS FOR ANIMAL TRAPPING**

(71) Applicant: **JAGER PRO, LLC**, Fortson, GA (US)

(72) Inventor: **Rodney Gene Pinkston**, Cataula, GA (US)

(73) Assignee: **JAGER PRO, LLC**, Fortson, GA (US)

(*) Notice: Subject to any disclaimer, the term of this patent is extended or adjusted under 35 U.S.C. 154(b) by 0 days.

This patent is subject to a terminal disclaimer.

(21) Appl. No.: **15/793,372**

(22) Filed: **Oct. 25, 2017**

(65) **Prior Publication Data**

US 2018/0055039 A1 Mar. 1, 2018

Related U.S. Application Data

(60) Division of application No. 15/071,423, filed on Mar. 16, 2016, now Pat. No. 9,814,228, which is a (Continued)

(51) **Int. Cl.**
A01M 23/20 (2006.01)
A01M 23/16 (2006.01)

(Continued)

(52) **U.S. Cl.**
CPC *A01M 31/002* (2013.01); *A01M 23/00* (2013.01); *A01M 23/16* (2013.01); (Continued)

(58) **Field of Classification Search**
CPC A01M 23/00; A01M 23/02; A01M 23/16; A01M 23/18; A01M 23/20; A01M 23/22 (Continued)

(56) **References Cited**

U.S. PATENT DOCUMENTS

1,182,018 A * 5/1916 Koenig E04H 17/18 119/510
4,596,087 A * 6/1986 Pratscher A01M 23/02 43/64

(Continued)

FOREIGN PATENT DOCUMENTS

DE 4216976 A1 * 11/1992 A01M 23/20
DE 19954142 A1 * 5/2001 A01M 23/20

(Continued)

OTHER PUBLICATIONS

Feral Hog Solutions (<http://feralhogsolutions.net/>), 3 pages, accessed Sep. 6, 2012.

(Continued)

Primary Examiner — Darren W Ark

(74) *Attorney, Agent, or Firm* — Ballard Spahr LLP

(57) **ABSTRACT**

A trap for capturing a plurality of animals is provided. The trap can comprise an enclosure having an opening through which the at least one animal can pass to enter the enclosure. A gate, movable between an open position and a closed position, is positioned therein the at least one opening and can be selectively moved from the open position to the closed position when desired. Methods are also provided for capturing at least one animal by providing a trap with a gate, positioning the gate in an open position, monitoring the trap until at least one animal has entered the trap, and remotely triggering the gate to move from the open position to a closed position.

20 Claims, 14 Drawing Sheets

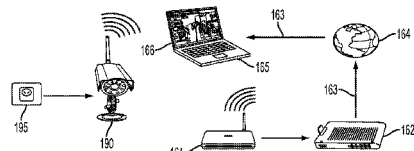
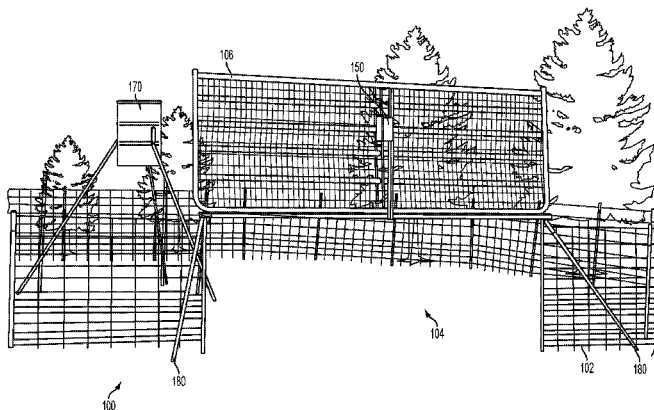

Related U.S. Application Data

- continuation of application No. 14/807,593, filed on Jul. 23, 2015, now abandoned, which is a continuation of application No. 13/004,747, filed on Jan. 11, 2011, now Pat. No. 9,101,126.
- (60) Provisional application No. 61/293,864, filed on Jan. 11, 2010.
- (51) **Int. Cl.**
A01M 23/00 (2006.01)
A01M 31/00 (2006.01)
G03B 29/00 (2006.01)
H04N 5/33 (2006.01)
H04N 7/18 (2006.01)
- (52) **U.S. Cl.**
 CPC *A01M 23/20* (2013.01); *A01M 31/00* (2013.01); *G03B 29/00* (2013.01); *H04N 5/33* (2013.01); *H04N 7/188* (2013.01); *H05K 999/99* (2013.01)
- (58) **Field of Classification Search**
 USPC 43/58, 60, 61, 62
 See application file for complete search history.

(56) **References Cited**

U.S. PATENT DOCUMENTS

4,965,959 A * 10/1990 Gagne A01M 1/06
 43/58
 5,185,953 A * 2/1993 Gross A01M 23/12
 43/58
 5,579,719 A * 12/1996 Hoff A01K 1/0209
 119/51.02
 6,088,948 A * 7/2000 Ronnau A01M 23/02
 43/64
 6,202,340 B1 * 3/2001 Nieves A01M 23/02
 43/61
 6,247,632 B1 * 6/2001 Howell B23K 3/087
 228/101
 6,427,632 B1 8/2002 Horst et al.
 6,456,320 B2 * 9/2002 Kuwano G08B 13/19602
 348/143
 6,710,714 B2 * 3/2004 Conway A01K 1/033
 119/712
 6,748,898 B2 * 6/2004 Ulman A01K 1/031
 119/51.02
 7,051,472 B1 * 5/2006 Kelly A01M 1/023
 43/58
 7,540,109 B2 * 6/2009 Hall A01M 23/20
 43/58
 7,656,300 B2 * 2/2010 Ronnau A01M 1/026
 340/506
 7,671,749 B2 * 3/2010 Alvarado A01M 29/06
 116/22 A
 7,854,088 B2 * 12/2010 Kurachi A01M 23/20
 43/58
 7,884,730 B2 * 2/2011 Alvarado A01M 31/002
 116/22 A
 8,061,076 B2 * 11/2011 Kelley A01M 23/20
 43/58
 8,112,934 B2 * 2/2012 Alter A01M 31/002
 43/58
 8,166,916 B2 * 5/2012 Larose A01K 1/0209
 119/51.02
 8,210,128 B1 * 7/2012 Lato A01K 1/0029
 119/14.03
 8,359,783 B1 * 1/2013 Kamery A01M 23/18
 43/58
 8,418,396 B2 * 4/2013 Moustirats A01M 31/002
 43/58

8,599,026 B2 * 12/2013 Lloyd A01M 31/002
 340/573.2
 8,635,806 B2 * 1/2014 Gardner, Jr. A01M 1/026
 43/107
 8,776,430 B1 * 7/2014 Kamery A01M 23/18
 43/58
 8,887,435 B2 * 11/2014 Ugiansky A01M 23/22
 43/60
 8,896,452 B2 * 11/2014 Oppenheimer H04Q 9/00
 340/540
 8,919,034 B2 * 12/2014 Alhuwaisheh A01K 69/06
 43/100
 9,003,691 B2 * 4/2015 Arlichson A01M 23/18
 43/61
 9,101,126 B2 * 8/2015 Pinkston A01M 23/20
 9,119,389 B2 * 9/2015 Perry A01M 23/16
 9,237,743 B2 * 1/2016 Gaskamp A01M 23/22
 9,545,094 B2 * 1/2017 Dykes A01M 23/20
 9,560,845 B2 * 2/2017 Hays H04W 4/70
 9,668,467 B2 * 6/2017 Gaskamp A01M 23/22
 9,814,228 B2 * 11/2017 Pinkston A01M 31/002
 2003/0213161 A1 * 11/2003 Gardner, Jr. A01M 1/026
 43/61
 2005/0097808 A1 * 5/2005 Vorhies A01M 23/18
 43/61
 2007/0248219 A1 * 10/2007 Foster H04M 11/007
 379/102.06
 2008/0048861 A1 * 2/2008 Naidoo G08B 13/19669
 340/541
 2008/0236023 A1 * 10/2008 Thomas A01M 23/24
 43/58
 2009/0051484 A1 * 2/2009 Foster G08C 17/02
 340/5.7
 2009/0225166 A1 * 9/2009 Dronge G08B 13/194
 348/155
 2011/0056117 A1 * 3/2011 Fritzbogger A01M 27/00
 43/73
 2011/0126777 A1 * 6/2011 Dunigan A01K 31/00
 119/713
 2012/0086547 A1 * 4/2012 Foster G08C 17/02
 340/5.7
 2013/0205645 A1 * 8/2013 Gaskamp A01M 23/16
 43/62
 2015/0059234 A1 3/2015 Dykes et al.
 2015/0296768 A1 * 10/2015 Hays H04W 4/70
 340/573.2
 2015/0313202 A1 * 11/2015 Perry A01M 23/16
 340/573.2
 2015/0327536 A1 * 11/2015 Pinkston A01M 23/20
 43/61
 2016/0050903 A1 2/2016 Gaskamp et al.
 2016/0127694 A1 * 5/2016 Chang A01M 23/16
 348/143
 2016/0277688 A1 * 9/2016 Gaskamp H04N 5/332
 2017/0035040 A1 * 2/2017 Hobbs A01M 23/00
 2018/0077919 A1 * 3/2018 McNew A01M 23/20

FOREIGN PATENT DOCUMENTS

DE 102006036513 A1 * 2/2008 A01M 31/002
 DE 102010054395 B4 * 2/2014 A01M 1/026
 FR 2663194 A1 * 12/1991 A01M 23/22
 FR 2819989 A1 * 8/2002 A01M 23/20
 FR 2832293 A1 * 5/2003 A01M 23/16
 GB 2469096 A * 10/2010 A01M 23/32
 JP 10004854 A * 1/1998
 JP 2002330687 A * 11/2002
 JP 2004097019 A * 4/2004
 JP 2006340627 A * 12/2006
 JP 2011083198 A * 4/2011
 JP 2012055232 A * 3/2012
 JP 2015057981 A * 3/2015
 KR 20080064791 A * 7/2008
 KR 20080109307 A * 12/2008

(56)

References Cited

OTHER PUBLICATIONS

West, B. et al. "Managing wild pigs: A technical guide. Human-Wildlife Interactions Monograph", 2009.

Wireless Traps (<http://www.wirelesstraps.com/index.html>), 2 pages, accessed Sep. 6, 2012.

Non Final Rejection dated Jan. 15, 2013 by the USPTO for U.S. Appl. No. 13/004,747, filed Jan. 11, 2011, now U.S. Pat. No. 9,101,126 Aug. 11, 2015 (Inventor-Rodney Gene Pinkston)(11 pages).

Response to Non Final Rejection dated May 7, 2013 to the USPTO for U.S. Appl. No. 13/004,747, filed Jan. 11, 2011, now U.S. Pat. No. 9,101,126 Aug. 11, 2015 (Inventor-Rodney Gene Pinkston)(12 pages).

Final Rejection dated Nov. 8, 2013 by the USPTO for U.S. Appl. No. 13/004,747, filed Jan. 11, 2011, now U.S. Pat. No. 9,101,126 Aug. 11, 2015 (Inventor-Rodney Gene Pinkston)(11 pages).

Response to Final Rejection dated Feb. 10, 2014 to the USPTO for U.S. Appl. No. 13/004,747, filed Jan. 11, 2011, now U.S. Pat. No. 9,101,126 Aug. 11, 2015 (Inventor-Rodney Gene Pinkston)(10 pages).

Request for Continued Examination (RCE) dated Apr. 8, 2014 to the USPTO for U.S. Appl. No. 13/004,747, filed Jan. 11, 2011, now U.S. Pat. No. 9,101,126 Aug. 11, 2015 (Inventor-Rodney Gene Pinkston)(13 pages).

Non Final Rejection dated Sep. 12, 2014 by the USPTO for U.S. Appl. No. 13/004,747, filed Jan. 11, 2011, now U.S. Pat. No. 9,101,126 Aug. 11, 2015 (Inventor-Rodney Gene Pinkston)(11 pages).

Response to Non Final Rejection dated Jan. 12, 2015 to the USPTO for U.S. Appl. No. 13/004,747, filed Jan. 11, 2011, now U.S. Pat. No. 9,101,126 Aug. 11, 2015 (Inventor-Rodney Gene Pinkston)(10 pages).

Notice of Allowance dated Apr. 23, 2015 by the USPTO for U.S. Appl. No. 13/004,747, filed Jan. 11, 2011, now U.S. Pat. No. 9,101,126 Aug. 11, 2015 (Inventor-Rodney Gene Pinkston)(8 pages).

Issue Notification dated Jul. 22, 2015 by the USPTO for U.S. Appl. No. 13/004,747, filed Jan. 11, 2011, now U.S. Pat. No. 9,101,126 Aug. 11, 2015 (Inventor-Rodney Gene Pinkston)(1 page).

Notice of Abandonment dated Jun. 30, 2016 by the USPTO for U.S. Appl. No. 14/807,593, filed Jul. 23, 2015, and published as US 2015-0327536 A1 on Nov. 19, 2015 (Inventor-Rodney Gene Pinkston)(2 pages).

Requirement for Restriction/Election dated Jul. 11, 2016 by the USPTO for U.S. Appl. No. 15/071,423, filed Mar. 16, 2016, now U.S. Pat. No. 9,814,228 Nov. 14, 2017 (Inventor-Rodney Gene Pinkston)(9 pages).

Response to Requirement for Restriction/Election dated Jul. 19, 2016 to the USPTO for U.S. Appl. No. 15/071,423, filed Mar. 16, 2016, now U.S. Pat. No. 9,814,228 Nov. 14, 2017 (Inventor-Rodney Gene Pinkston)(8 pages).

Non Final dated Sep. 29, 2016 by the USPTO for U.S. Appl. No. 15/071,423, filed Mar. 16, 2016, now U.S. Pat. No. 9,814,228 Nov. 14, 2017 (Inventor-Rodney Gene Pinkston)(17 pages).

Response to Non Final dated Dec. 2, 2016 to the USPTO for U.S. Appl. No. 15/071,423, filed Mar. 16, 2016, now U.S. Pat. No. 9,814,228 Nov. 14, 2017 (Inventor-Rodney Gene Pinkston)(15 pages).

Final dated Mar. 23, 2017 by the USPTO for U.S. Appl. No. 15/071,423, filed Mar. 16, 2016, now U.S. Pat. No. 9,814,228 Nov. 14, 2017 (Inventor-Rodney Gene Pinkston)(20 pages).

Response to Final dated Jun. 23, 2017 to the USPTO for U.S. Appl. No. 15/071,423, filed Mar. 16, 2016, now U.S. Pat. No. 9,814,228 Nov. 14, 2017 (Inventor-Rodney Gene Pinkston)(22 pages).

Notice of Allowance dated Sep. 29, 2017 by the USPTO for U.S. Appl. No. 15/071,423, filed Mar. 16, 2016, now U.S. Pat. No. 9,814,228 Nov. 14, 2017 (Inventor-Rodney Gene Pinkston)(12 pages).

Notice of Allowance dated Oct. 12, 2017 by the USPTO for U.S. Appl. No. 15/071,423, filed Mar. 16, 2016, now U.S. Pat. No. 9,814,228 Nov. 14, 2017 (Inventor-Rodney Gene Pinkston)(5 pages).

Issue Notification dated Oct. 25, 2017 by the USPTO for U.S. Appl. No. 15/071,423, filed Mar. 16, 2016, now U.S. Pat. No. 9,814,228 Nov. 14, 2017 (Inventor-Rodney Gene Pinkston)(1 page).

* cited by examiner

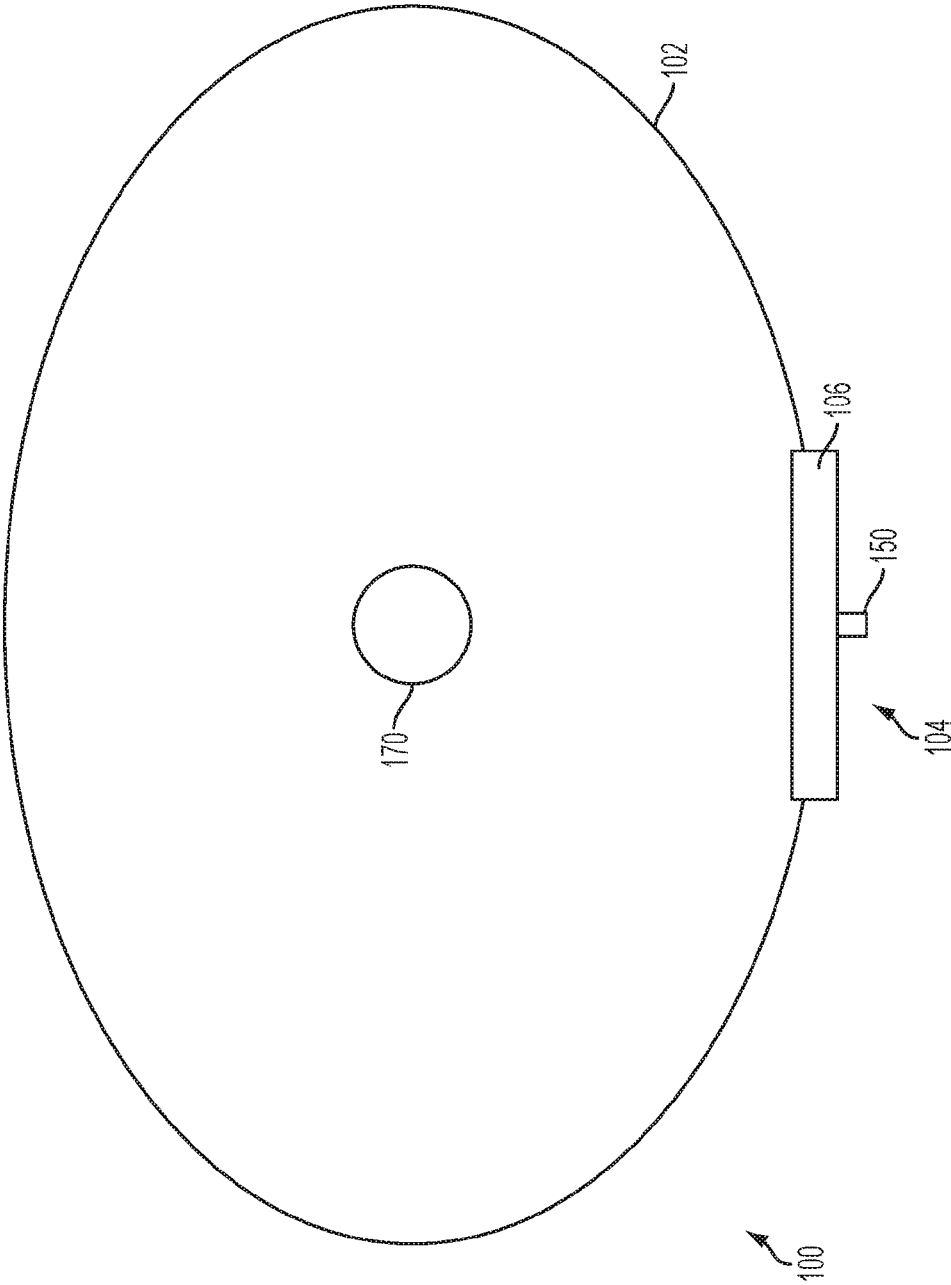
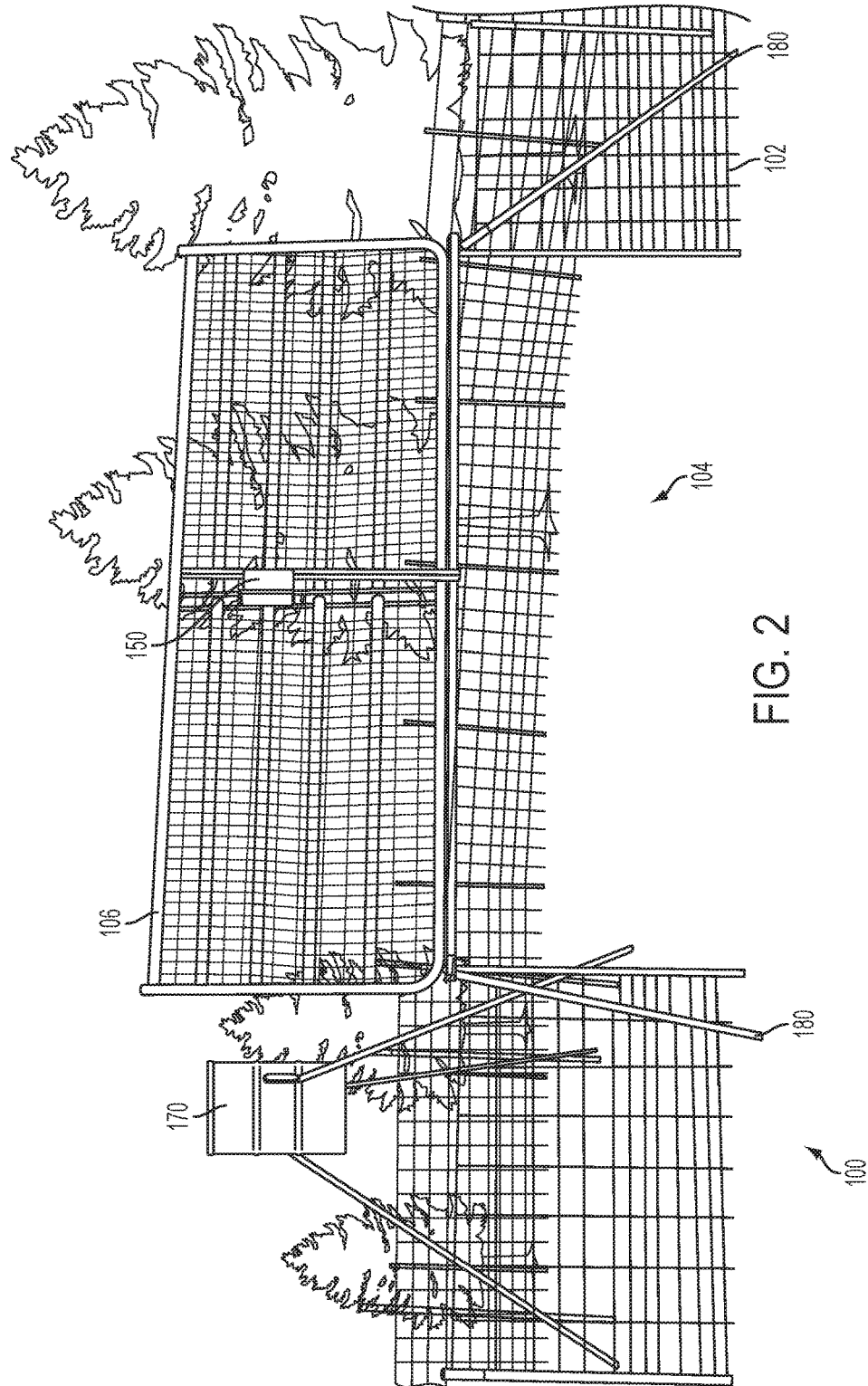

FIG. 1



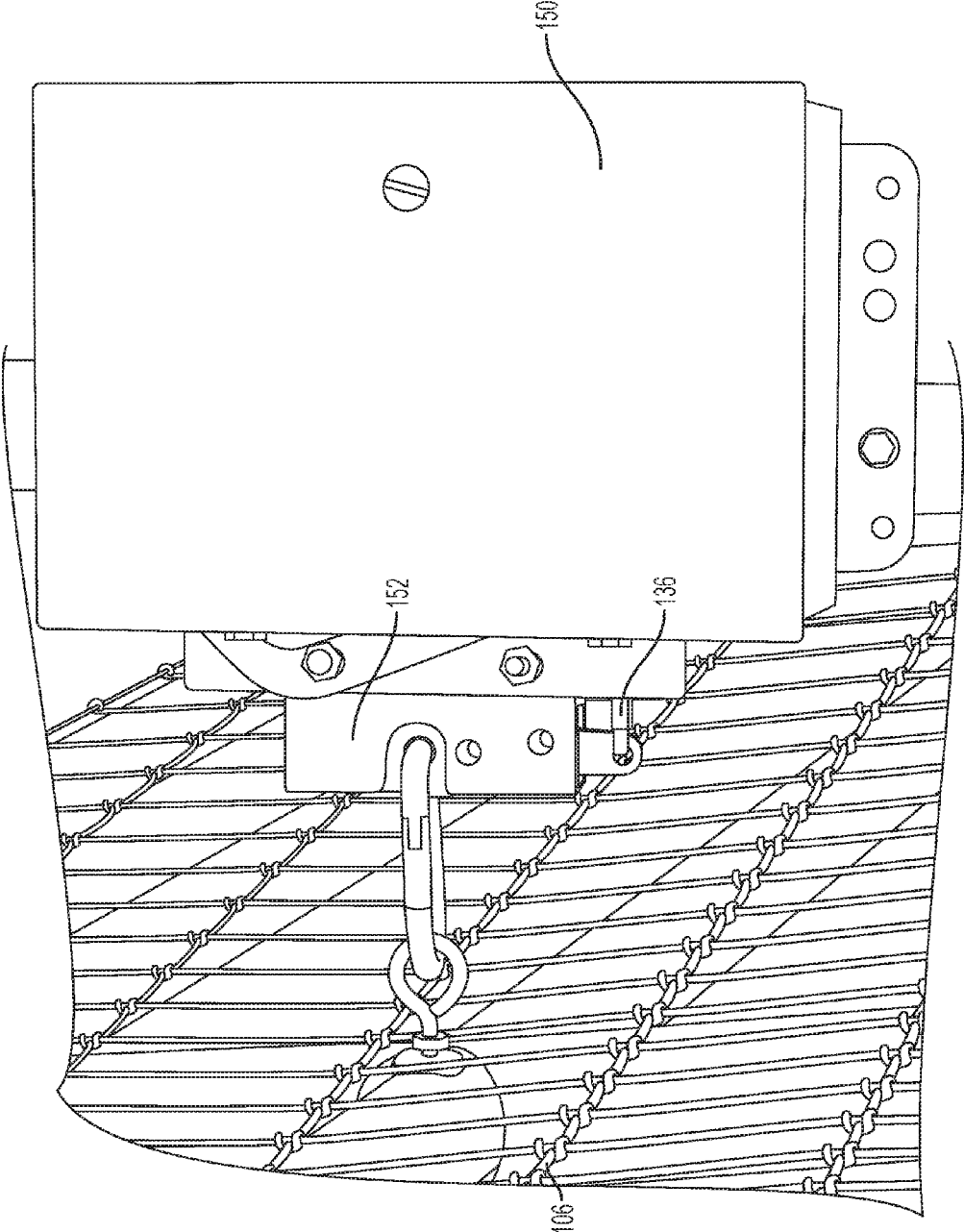

FIG. 3

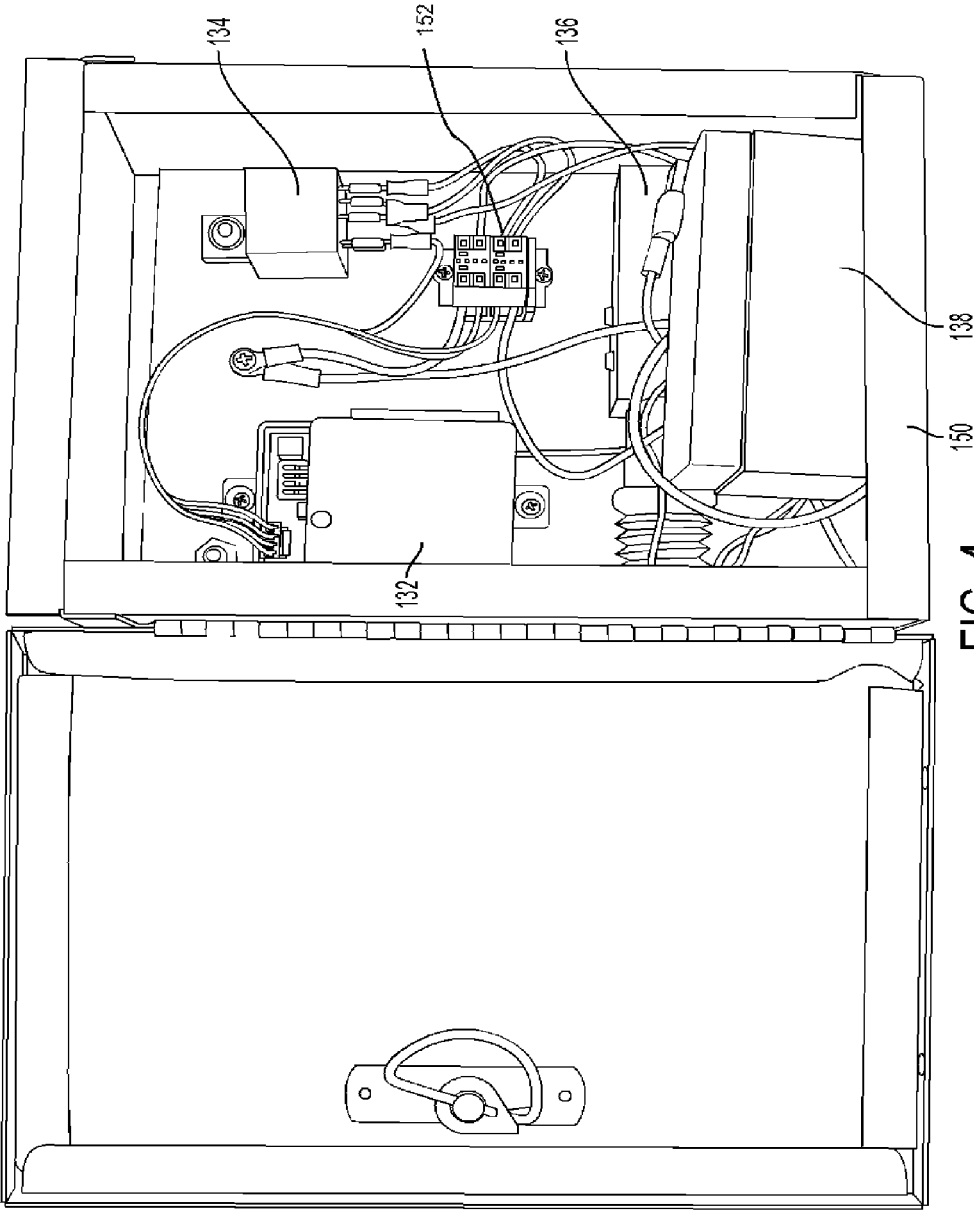

FIG. 4

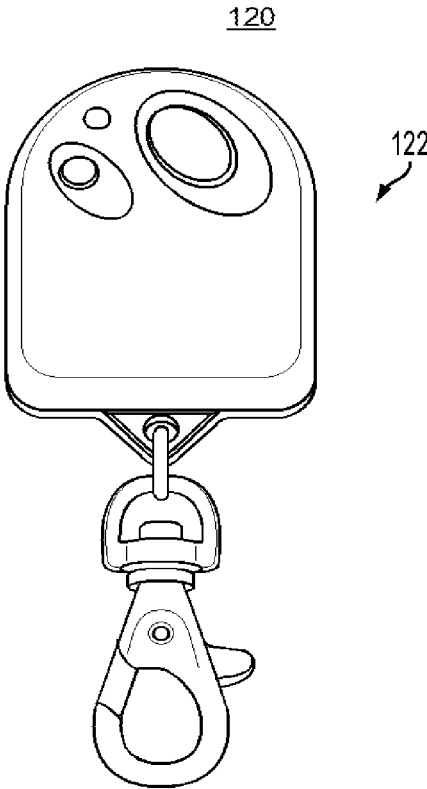

FIG. 5

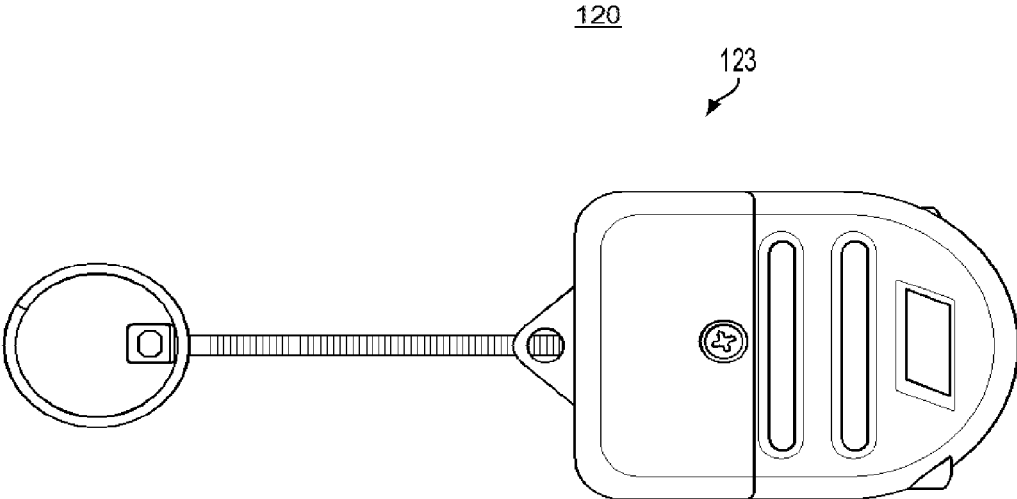

FIG. 6

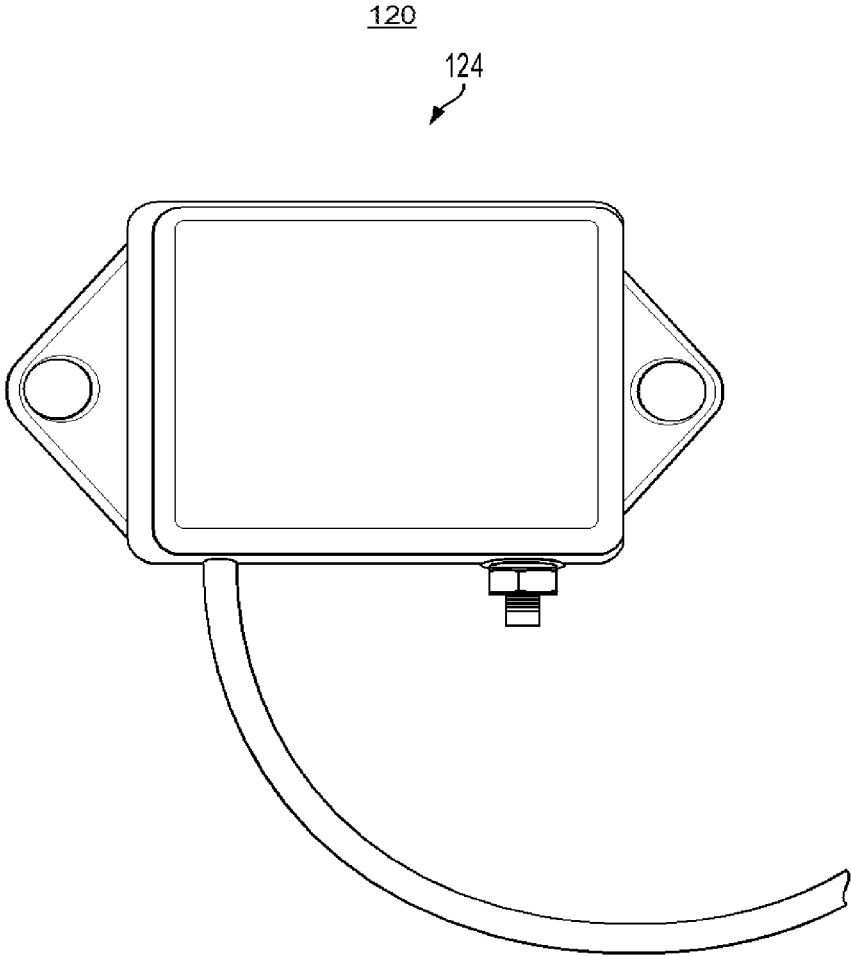

FIG. 7

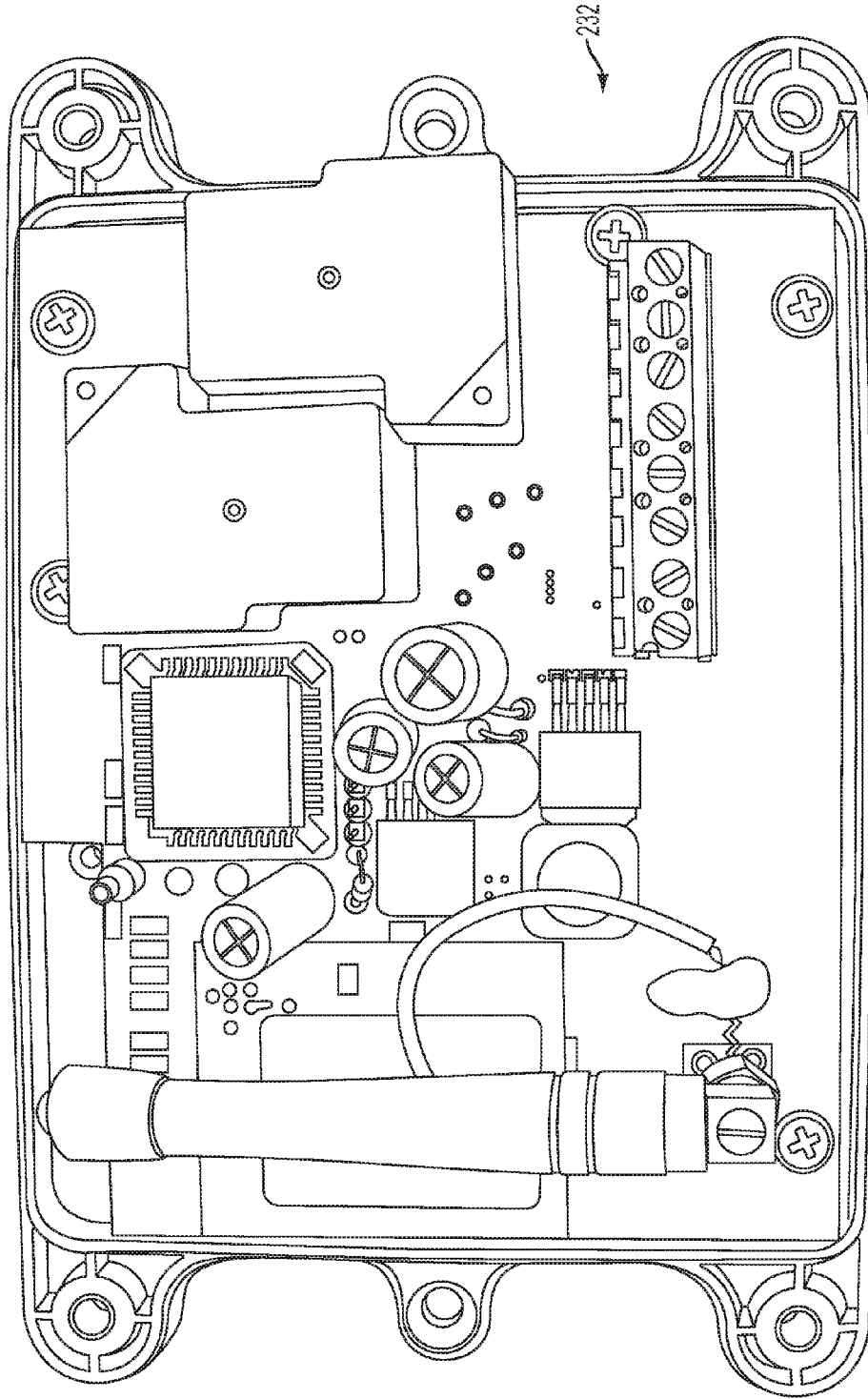

FIG. 8

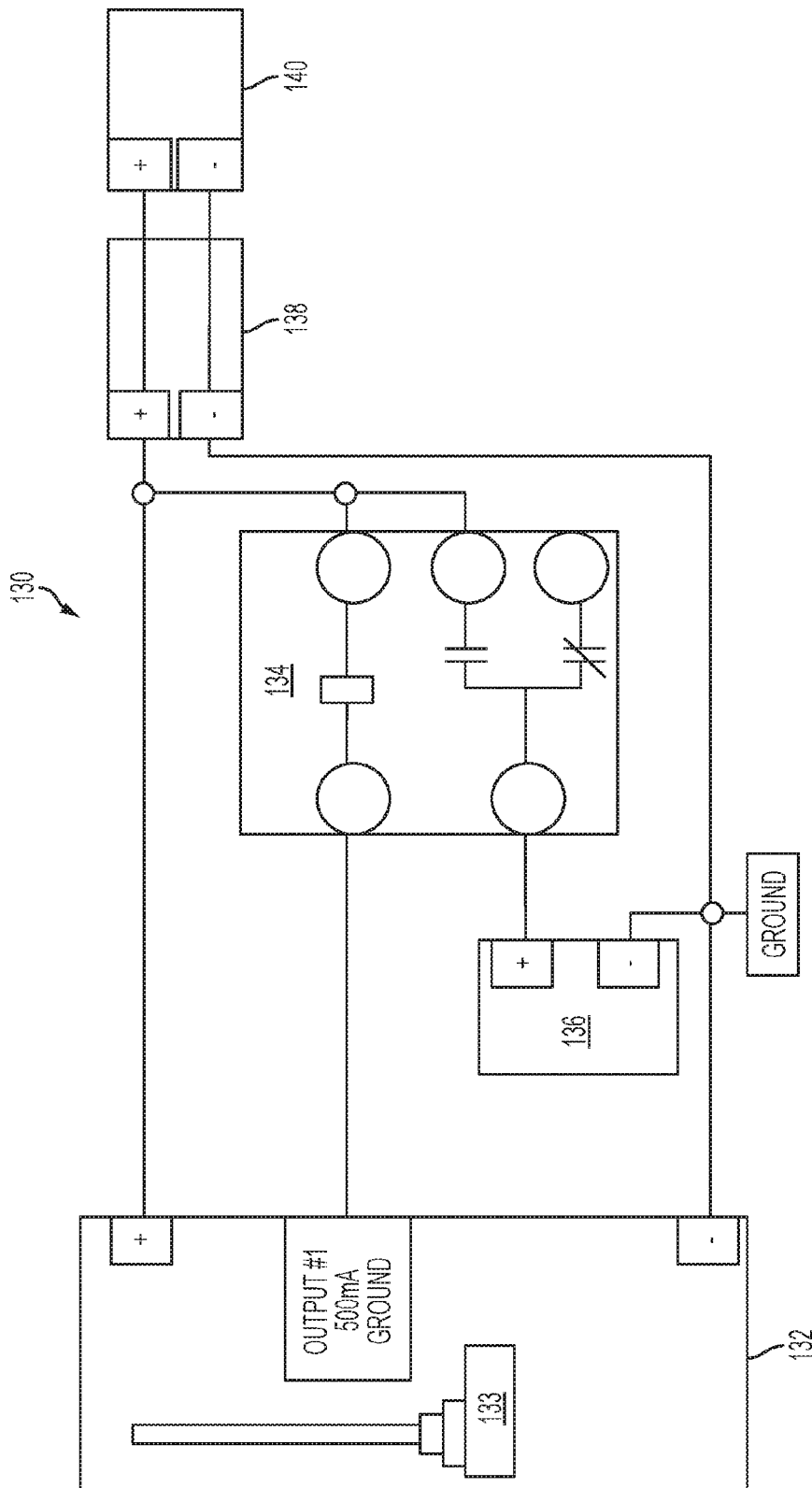

FIG. 9

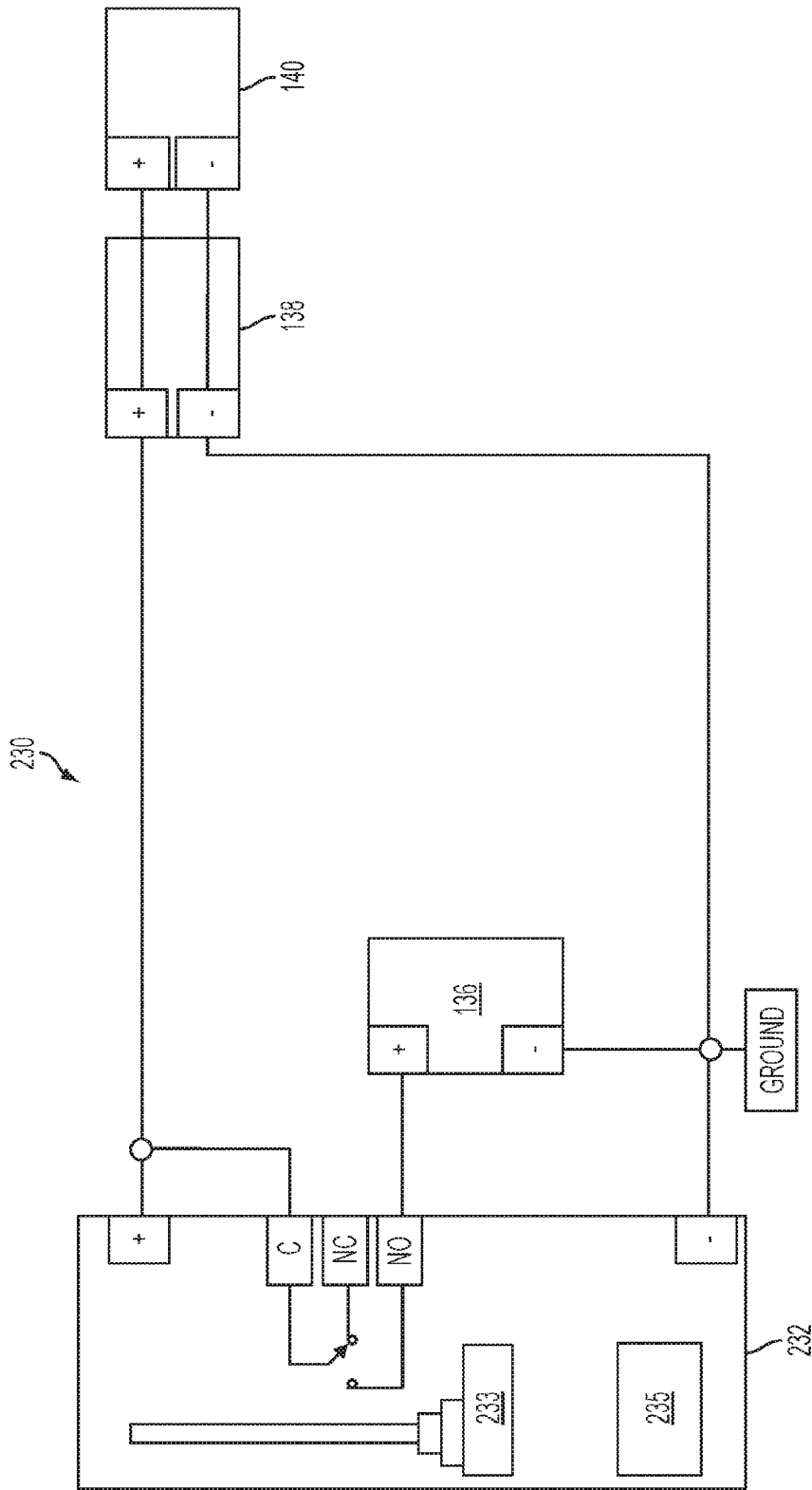

FIG. 10

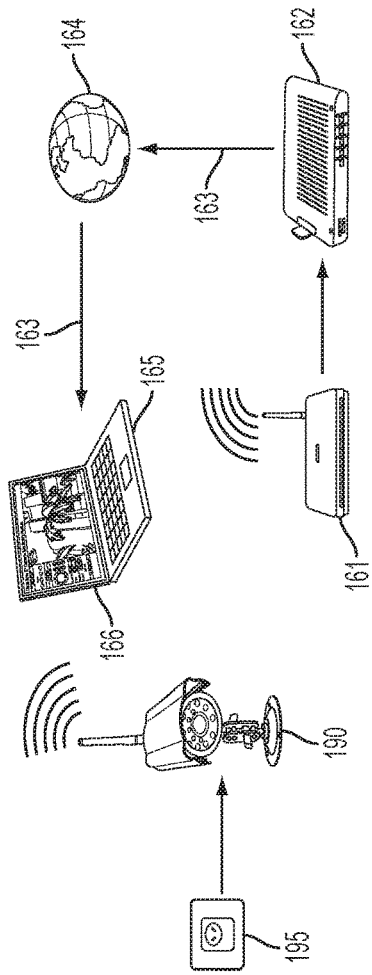

FIG. 11A

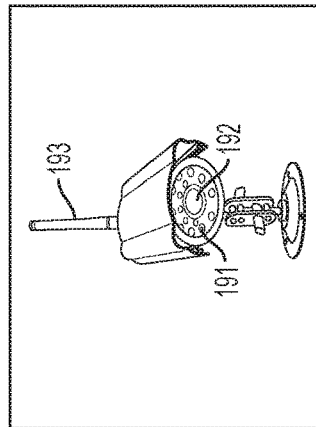

FIG. 11B

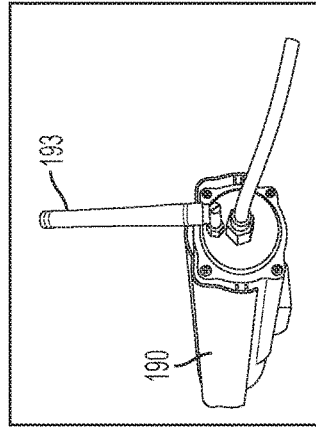

FIG. 11C

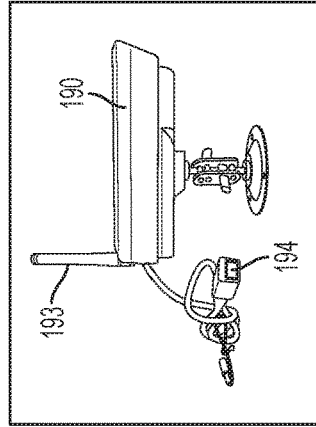

FIG. 11D



FIG. 11E

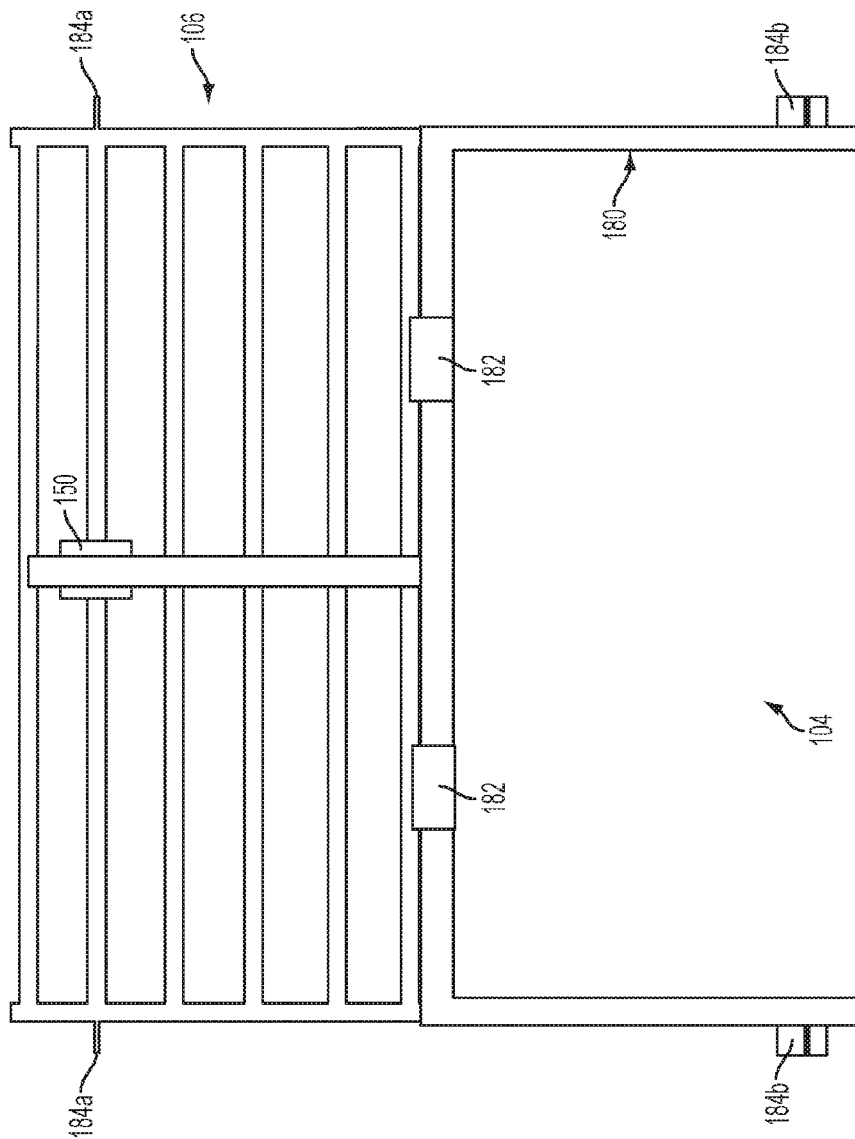

FIG. 12A

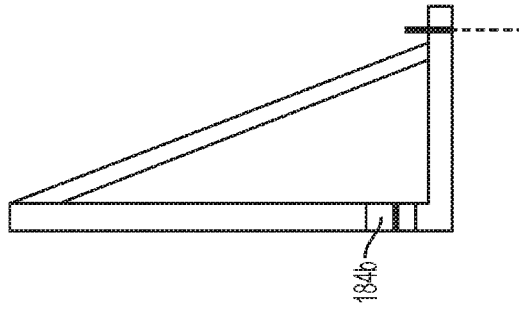

FIG. 12B

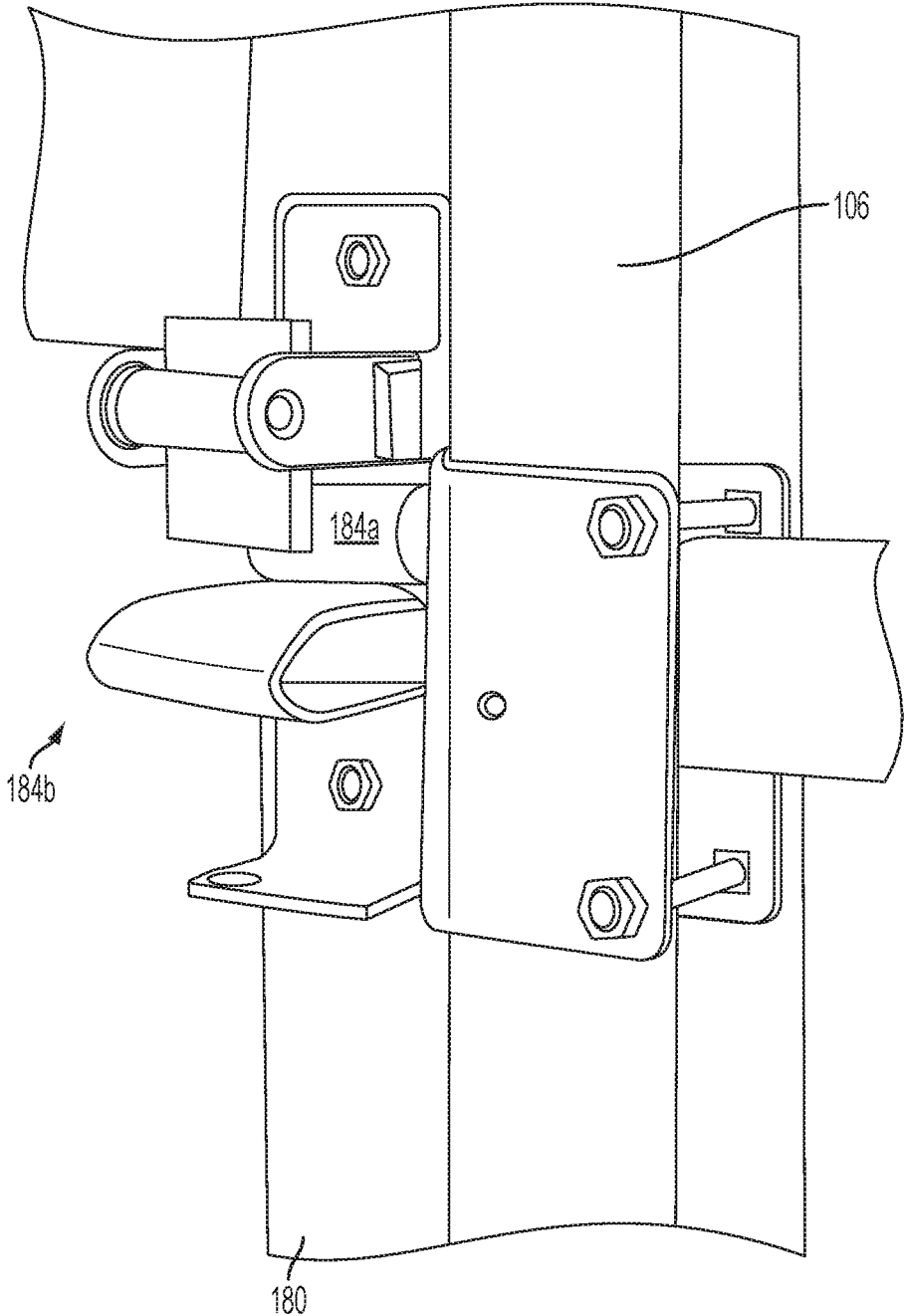

FIG. 12C

SYSTEMS AND METHODS FOR ANIMAL TRAPPING

CROSS REFERENCE TO RELATED APPLICATIONS

This application is a divisional of U.S. patent application Ser. No. 15/071,423, filed Mar. 16, 2016 and entitled "Systems and Methods for Animal Trapping," which is a continuation of U.S. patent application Ser. No. 14/807,593, filed Jul. 23, 2015, which is a continuation of U.S. patent application Ser. No. 13/004,747, filed Jan. 11, 2011, now U.S. Pat. No. 9,101,126, which claims the benefit of and priority to U.S. Provisional Patent Application Ser. No. 61/293,864, filed Jan. 11, 2010, each of which is incorporated herein by reference in its entirety.

FIELD OF THE INVENTION

Provided are traps for trapping a at least one animal. More specifically, traps are provided for remotely trapping nuisance wildlife such as rats, feral pigs, and the like.

BACKGROUND

Animal overpopulation and expensive crop damage have become a serious problem in many rural, suburban and urban areas. One example of this problem is the feral pig population explosion currently affecting farmers and land owners in at least 39 states. Conventional gates on trap enclosures are typically designed to be triggered and closed when an animal enters into the trap enclosure, or is otherwise sensed inside the trap enclosure. However, where high populations of nuisance animals are present, this method often produces low volume capture numbers and future trap avoidance by non-captured animals.

Thus, there is a need in the art for trap enclosures and methods for trapping animals that provide high-volume capture of nuisance animals.

SUMMARY

In accordance with the purposes of this invention, as embodied and broadly described herein, in one aspect, a trap for capturing at least one animal is provided, according to one aspect. In another aspect, the trap can comprise an enclosure having at least one opening through which the at least one animal can pass. In another aspect, a gate, movable between an open position and a closed position, can be positioned therein the at least one opening. In still another aspect, the trap can comprise means for remotely selectively triggering the gate to move the gate from the open position to the closed position when a desired condition has been met.

According to other aspects, methods are provided for capturing at least one animal. A trap can be provided comprising an enclosure having an opening through which at least one animal can pass, a gate positioned in the opening that can be movable between an open position and a closed position, a transmitter configured to transmit a signal, and a remote control mechanism comprising a receiver configured to receive the signal from the transmitter. The remote control mechanism can be configured to move the gate from the open position to the closed position in response to the received signal. Exemplary methods can further comprise positioning the gate in the open position, monitoring the trap

until at least one animal has entered the trap, and remotely triggering the gate to move from the open position to the closed position.

Additional advantages will be set forth in part in the description which follows, and in part will be obvious from the description, or may be learned by practice of the aspects of the invention as described herein. The advantages can be realized and attained by means of the elements and combinations particularly pointed out in the appended claims. It is to be understood that both the foregoing general description and the following detailed description are exemplary and explanatory only and are not restrictive of the aspects of the invention, as claimed.

BRIEF DESCRIPTION OF THE DRAWINGS

The accompanying drawings, which are incorporated in and constitute a part of this specification, illustrate aspects of the invention and, together with the description, serve to explain the principles of the invention.

FIG. 1 is a top plan view of an exemplary trap, according to one aspect.

FIG. 2 illustrates an exemplary trap, showing a gate of the trap in an open position, according to one aspect.

FIG. 3 illustrates a housing and gate release mechanism in use on a trap, according to one aspect.

FIG. 4 is front internal view of a housing and gate release mechanism of a trap of the present application, according to one aspect.

FIG. 5 illustrates a hand-held, push button-activated wireless transmitter, according to one aspect.

FIG. 6 illustrates a trip wire, pull pin-activated wireless transmitter, according to one aspect.

FIG. 7 illustrates a motion sensor-activated wireless transmitter, according to one aspect.

FIG. 8 illustrates the circuit board of a cell phone controller, according to one aspect.

FIG. 9 is a schematic diagram of exemplary means for remotely triggering a gate of a trap, according to one aspect.

FIG. 10 is a schematic diagram of exemplary means for remotely triggering a gate of a trap using a cell phone controller, according to another aspect.

FIG. 11A is a schematic diagram of an internet protocol (IP) web camera network and installation for offsite monitoring and control of a trap, according to one aspect.

FIG. 11B is a front view of an exemplary infrared camera of the IP web camera network of FIG. 11A.

FIG. 11C is a rear view of the exemplary infrared camera of FIG. 11B.

FIG. 11D is a side view of the exemplary infrared camera of FIG. 11A.

FIG. 11E illustrates an exemplary user interface of the IP web camera network of FIG. 11A.

FIG. 12A illustrates a front view of an exemplary gate and gate support frame of a trap, according to another aspect.

FIG. 12B illustrates a side view of the exemplary gate support frame of FIG. 12A.

FIG. 12C illustrates a locking mechanism for the gate and gate support frame of FIG. 12A.

DETAILED DESCRIPTION

Aspects of the present invention may be understood more readily by reference to the following detailed description, examples, drawings, and claims, and their previous and following description. However, before the present devices, systems, and/or methods are disclosed and described, it is to

be understood that aspects of this invention are not limited to the specific devices, systems, and/or methods disclosed unless otherwise specified, as such can, of course, vary. It is also to be understood that the terminology used herein is for the purpose of describing particular aspects only and is not intended to be limiting.

As used in the specification and the appended claims, the singular forms “a,” “an” and “the” include plural referents unless the context clearly dictates otherwise. Thus, for example, reference to an “animal” can include two or more such animals unless the context indicates otherwise.

Ranges may be expressed herein as from “about” one particular value, and/or to “about” another particular value. When such a range is expressed, another embodiment includes from the one particular value and/or to the other particular value. Similarly, when values are expressed as approximations, by use of the antecedent “about,” it will be understood that the particular value forms another embodiment. It will be further understood that the endpoints of each of the ranges are significant both in relation to the other endpoint, and independently of the other endpoint.

As used herein, the terms “optional” or “optionally” mean that the subsequently described event or circumstance may or may not occur, and that the description includes instances where said event or circumstance occurs and instances where it does not.

Reference will now be made in detail to the present preferred aspect(s) of the invention, examples of which are illustrated in the accompanying drawings. Wherever possible, the same reference numbers are used throughout the drawings to refer to the same or like parts.

In one aspect, a trap **100** is provided for capturing a plurality of animals. Although used herein to describe the capture of feral pigs, it is contemplated that the traps described herein can be used to trap any animal (or a variety of animals). As shown in FIGS. **1** and **2**, for example, the trap, in one aspect, can comprise an enclosure **102** having at least one opening **104** through which the plurality of animals can pass. In one aspect, the enclosure can be substantially circular, though other shapes, such as substantially triangular, substantially square, substantially rectangular, and the like are contemplated. In one aspect, a circular or generally rounded trap (i.e., elliptical, rectangular with rounded corners, etc.) can provide a large trap area while avoiding corners in which trapped animals will pile up. A rounded trap can also provide for good flow of animals inside the trap. In still another aspect, the enclosure can be irregularly shaped.

In another aspect, the enclosure can be a relatively large enclosure such that the plurality of animals does not feel confined either entering or loitering in the relatively large area of the enclosure. For example, the enclosure can have an area of at least about 5 feet², 10 feet², 20 feet², 30 feet², 40 feet², 50 feet², 100 feet², 200 feet², 500 feet², 1000 feet², 1500 feet², 2000 feet², 3000 feet², 4000 feet², 5000 feet², 10,000 feet², 20,000 feet², 30,000 feet², 40,000 feet², 1 acre, 2 acres, 3 acres, 4 acres, 5 acres and greater than 5 acres. In another aspect, the at least one opening can be sufficiently sized such that animal(s) does not feel confined entering the at least one opening. For example, the at least one opening can have a width of at least about 1 foot, 2 feet, 3 feet, 4 feet, 5 feet, 6 feet 7 feet, 8 feet, 9 feet, 10 feet, 11 feet, 12 feet, 13 feet, 14 feet, 15 feet and greater than 15 feet. In one particular aspect, the at least one opening can be approximately 12 feet wide.

In one aspect, the trap can comprise a door or gate **106** positioned in the at least one opening of the enclosure, such

as shown in FIGS. **1** and **2**. The terms “door” and “gate” are used interchangeably herein. The gate can be movable between an open position (such as shown in FIGS. **2** and **12A**) and a closed position. In another aspect, the trap can also comprise means for remotely triggering the gate to move the gate from the open position to the closed position. According to various aspects, and as described further herein below, it is contemplated that the exemplary traps described herein can be left open for a period of time, and the gate can be remotely triggered at a time when it is determined that a desired number of animals will be trapped therein the enclosure.

In one aspect, a transmitter **120** and remote control mechanism **130** are provided for remotely triggering the gate. The transmitter can be configured to transmit a signal, and the remote control mechanism can be configured to receive the signal from the transmitter. In one aspect, at least a portion of the remote control mechanism **130** can be housed in a housing **150**, such as shown in FIGS. **3** and **4**. In one aspect, the housing can be a weatherproof housing. The remote control mechanism **130** can comprise a receiver **132** configured to receive the signal from the transmitter (such as wirelessly via the antenna **133**), and can be configured to move the gate from the open position to the closed position in response to the received signal. According to another aspect, as shown in FIG. **9** for example, the remote control mechanism can comprise a relay **134** electrically coupled to the receiver **132**, a solenoid **136**, and a battery **138** or other power source. In another aspect, a solar charger **140** can be provided to charge the battery **138** or other power source. According to one particular aspect, for example, the remote control mechanism can comprise a relay, such as a 30 amp relay and the like, a battery source, such as a 12 volt, 1.4 amp direct current battery source and the like, and a push/pull solenoid or the like.

According to another aspect, a remote control mechanism **230** can be provided for remotely triggering the gate with the use of a cellular telephone (“cell phone”) as a transmitter, and a cell phone controller **232** acting as a receiver, such as shown in FIG. **10**. The cell phone controller **232** can comprise a wireless remote control on/off switch, and can be configured to move the gate from the open position to the closed position in response to a phone call. As shown in FIG. **10**, for example, the cell phone controller can comprise a relay electrically coupled to a solenoid **136** and a battery **138**. As discussed above, a solar charger **140** can be provided to charge the battery **138** (or other power source). According to one particular aspect, for example, the cell phone controller **232** can comprise an antenna **233** and a SIM card holder **235** and the like. An exemplary cell phone controller circuit board is shown in FIG. **8**.

In another aspect, such as shown in FIG. **3**, the remote control mechanism **130** can also comprise a gate release mechanism **152** operatively coupled to the solenoid. In this aspect, the gate release mechanism can be configured to maintain the gate **106** of the enclosure in a desired position, such as the open position so that the at least one animal can enter the enclosure. In another aspect, the gate release mechanism can be a latch, an arm, a hook, a catch, and the like. As shown in FIGS. **3** and **4**, the solenoid **136** can extend out of the housing to control the gate release mechanism **152**. As can be appreciated, the gate **106** can be supported by a support frame **180**, as shown in FIGS. **12A** and **12B**. The support frame can be constructed from a variety of materials, including but not limited to steel. The gate can be supported by the support frame by one or more hinges **182**, which can allow the gate to pivot from the open position to the closed

position. As can be appreciated, according to another aspect, the gate can be slidable along or within the frame from the open position to the closed position.

According to a further aspect, such as shown in FIGS. 12A-12C, a locking mechanism can be provided on the gate and the gate support frame to maintain or secure the gate in the closed position in order to prevent animals from escaping the trap. As shown in FIGS. 12A-12C, the locking mechanism can comprise a pin or other protrusion **184a** on the gate, which cooperates with a latch **184b** that is affixed to the gate support frame. As can be appreciated, when the gate is moved to the closed position, the pin or other protrusion **184a** can be securely received by the latch **184b** (as shown in FIG. 12C). As can be appreciated, the pin can be manually released from the latch when desired by a user, such as to release one or more of the animals, or to reopen the gate for further capture of animals. Other conventional locking means can, of course, be used to secure the gate in the closed position.

In operation, when the receiver **132** receives a signal from the transmitter **120**, the receiver activates an output signal. In one aspect, the output signal can be activated as long as the transmitter is transmitting a signal to the receiver. In one aspect, the output signal from the receiver can be received by the relay **134**, causing the relay to close, thereby sending a signal to the solenoid **136**. The solenoid can trigger the gate release mechanism **152** to move the gate from the open position to the closed position. In one non-limiting example, in operation, when the receiver receives a signal from the transmitter, the receiver supplies a 500 mA negative ground to the 30 amp relay. The relay closes sending a 12 volt direct current output to the push/pull solenoid, which triggers the gate release mechanism to move the gate from the open position to the closed position.

According to another aspect, a cell phone controller **232** can receive a signal from a transmitter. The cell phone controller can be activated by a signal from its programmed cell phone number. In one aspect, the cell phone controller will reject the call without answering, while closing the normally open contacts, thereby sending a signal to the solenoid **136**. The solenoid **136** triggers the gate release mechanism to move the gate from the open position to the closed position.

According to various aspects, the transmitter **120** can be configured for wireless communication with the receiver. Thus, in one aspect, the transmitter can be any device capable of transmitting a wireless signal to—or otherwise being in wireless communication with—the receiver. The transmitter can be a hand-held, push button-activated wireless transmitter such as a key fob **122** (as exemplarily shown in FIG. 5), a pull pin-activated wireless transmitter **123** (as exemplarily shown in FIG. 6), a motion sensor-activated wireless transmitter **124** (as exemplarily shown in FIG. 7), a remote control, a cellular telephone, or other such device. As can be appreciated, if a key fob **122** is used as a transmitter, a user can press a button on the key fob when the user desires to close the gate of the trap. In another aspect, a trip wire can be installed within the trap; when an animal touches the trip wire, it will cause the pull pin in the pull pin-activated wireless transmitter **123** to be pulled, causing a wireless signal to be transmitted to the receiver to close the gate (as discussed above). In one aspect, such a trip wire can be positioned in the trap at a distance from the gate, such that it will not be tripped until one or more animals are well within the trap when the gate is moved from the open to the

closed position. According to other aspects, the transmitter can be configured for wired communication with the receiver.

The trap can also comprise means for detecting the presence of at least one animal therein the enclosure. For example, and not meant to be limiting, a camera can be provided in the enclosure, or near the enclosure, and can be configured to record or sense the presence of the at least one animal therein the enclosure. In one aspect, the camera can be a closed-circuit device or an internet protocol (IP) web camera intended to continuously broadcast a transmission to a closed circuit television or other monitoring device, such as, for example, an IP web camera network. In another aspect, the camera can also be an infrared camera, configured to record the thermal image of the at least one animal therein the enclosure. In still another aspect, the camera can be a night vision camera configured to record the image of the at least one animal therein the enclosure. Such exemplary means for detecting the presence of the at least one animal can be configured to record still or moving images to any suitable computer-readable storage medium including hard disks, CD-ROMs, optical storage devices, or magnetic storage devices or to other recording devices (such as video tape recorder). In another aspect, the means for detecting the presence of the at least one animal can be configured to transmit the recorded images to a remote display device, such as a monitor.

In one aspect, such as shown in FIGS. 11A-11E, a camera **190** can be provided as part of an IP web camera network. The infrared camera can have infrared or LED lights **191**, a lens **192**, and an antenna **193** configured for wireless transmission. The camera can also have a power source **195**, such as a direct current power source, and can have an RJ45 port **194**, as shown in FIG. 11D. The camera can transmit its images to a computer via a conventional wireless internet system, which can include a wireless router **161** and a modem **162**, which transmit information via the internet to a computer **165** that has a display device, such as a monitor **166**. As can be appreciated, the modem and computer can be in communication with the internet **164** via network cables **163** or other conventional means. Of course, other means of transmitting the camera image(s) to a computer or other display device are contemplated, and are not limited to the wireless network shown in FIG. 11A. According to another aspect, the camera can transmit image(s) to a wireless handheld device, such as a cellular telephone, personal digital assistant (PDA), or other such device. Any such device having means of displaying the images to a user can include a user interface **168** (shown in FIG. 11E), which can allow the user to adjust the image (e.g., brightness, contrast), and can also allow the user to manipulate the camera wirelessly (e.g., by panning and/or zooming the camera to capture different images).

In another aspect, the means for detecting the presence of the at least one animal can be configured or otherwise programmed to automatically trigger the gate when a predetermined condition has been met. In various aspects, the predetermined condition can be a certain date and/or time, a predetermined level of food remaining in a food dispensing mechanism (described further below), a predetermined number of animals detected in the enclosure by the camera or a local person, and the like.

According to yet other exemplary aspects, as shown for example in FIG. 2, the trap can comprise a food dispensing mechanism **170**, such as but not limited to a substantially automatic food dispensing mechanism. The food dispensing mechanism can be positioned therein the enclosure **102** and

can be configured to provide food to at least one animal in the enclosure. In one aspect, the food dispensing mechanism 170 can be positioned substantially centrally within the enclosure. In other aspects, however, the food dispensing mechanism can be positioned at any location within the enclosure. In one aspect, the food dispensing mechanism can provide food at a predetermined time or at predetermined intervals (such as every twelve hours, daily, nightly, etc.). The food dispensing mechanism can be used, for example, to lure animals into the enclosure. The enclosure can be left open for selected periods of time (such as hours, days, weeks, etc.) prior to the capture of animals. The use of an automatic feeder can allow the animals to come and go into the enclosure and come to trust the enclosure as a food source area. Additionally, the use of an automatic or substantially automatic food dispensing mechanism 170 allows the scent of humans around the trap to be minimized or eliminated, thereby minimizing the chances that animals will avoid entering the trap.

Repeated use of the enclosure by the animals over several days or weeks can allow the animals to recruit other animals to the area for higher volume trapping results. For example, feral pigs are known to travel in packs and groups. As more pigs are drawn to the enclosure as a food source, they will travel outside of the enclosure to recruit more pigs to enter the enclosure. The enclosure can be monitored (such as locally, or remotely via the means for detecting the presence of an animal therein the enclosure), until such time as it is desired to close the gate to the enclosure, thereby trapping animals inside of the enclosure.

According to one aspect, it is contemplated that the animals trapped inside of the enclosure can be removed from the enclosure and disposed of according to conventional means. In one aspect, for example when the trap is used to trap feral pigs, one or more pigs (hereinafter, a "Judas pig") can be kept alive and can be used to track the location of other groups of feral pigs. For example, such a Judas pig can be tagged with a radio telemetry device and can be released. The Judas pig will naturally migrate to other groups of feral pigs. When the location of other groups of feral pigs is determined, a new trap, such as described above, can be set up to capture the new group of pigs. In one aspect, it is contemplated to use a female adult or sub-adult feral pig as the Judas pig.

It will be apparent to those skilled in the art that various modifications and variations can be made in the present invention without departing from the scope or spirit of the invention. Other embodiments of the invention will be apparent to those skilled in the art from consideration of the specification and practice of the invention disclosed herein. It is intended that the specification and examples be considered as exemplary only, with a true scope and spirit of the invention being indicated by the following claims.

What is claimed is:

1. A trapping system for capturing at least one wild animal, comprising:

an enclosure having at least one portion that is movable between an open position that permits passage of at least one wild animal into the enclosure and a closed position that restricts passage of at least one wild animal out of the enclosure;

a camera assembly configured to transmit a wireless detection signal;

a display device in communication with the camera assembly and configured to:

receive the wireless detection signal from the camera assembly, and

transmit a wireless control signal upon receipt of the wireless detection signal from the camera assembly;

a control mechanism in communication with the display device and configured to receive the wireless control signal from the display device, wherein the wireless control signal corresponds to an instruction to the control mechanism to generate a release signal;

a release mechanism in communication with the control mechanism and configured to effect movement of the at least one portion of the enclosure from the open position to the closed position in response to receipt of the release signal from the control mechanism,

wherein, upon detection of a presence of the at least one wild animal within the enclosure by the camera assembly, the camera assembly transmits the wireless detection signal to the display device.

2. The trapping system of claim 1, further comprising:

a relay in operative communication with the control mechanism;

a solenoid positioned in operative communication with the relay and operatively coupled to the release mechanism; and

a battery in operative communication with the relay and the control mechanism,

wherein in response to receipt of the wireless control signal from the display device, the control mechanism is configured to send a release signal to the relay, the relay is configured to trigger the battery to send a direct current output to the solenoid, and the solenoid is configured to trigger the release mechanism to move the at least one portion of the enclosure to the closed position.

3. The trapping system of claim 1, wherein the display device comprises at least one of a computer, a wireless handheld device, a remote control, a user interface, or a telephone.

4. The trapping system of claim 1, wherein the camera assembly is configured to transmit an image of the at least one wild animal within the enclosure to the display device.

5. The trapping system of claim 4, wherein the display device is a wireless handheld device.

6. The trapping system of claim 5, wherein the wireless handheld device is a cellular telephone.

7. The trapping system of claim 6, wherein the wireless detection signal and the wireless control signal are transmitted via a cellular network.

8. The trapping system of claim 1, wherein the camera assembly comprises a motion sensor that is configured to sense the presence of the at least one wild animal within the enclosure.

9. The trapping system of claim 1, wherein the display device comprises a plurality of display devices and the camera assembly is configured to transmit the wireless detection signal to the plurality of display devices.

10. The trapping system of claim 1, wherein the display device comprises a telephone, wherein the control mechanism comprises a telephone controller, and wherein the telephone is configured to transmit the wireless control signal to the telephone controller, wherein the telephone controller is configured to receive the wireless control signal from the telephone and wherein the release mechanism is configured to effect movement of the at least one portion of the enclosure from the open position to the closed position in response to the received signal from the telephone.

11. The trapping system of claim 1, wherein the camera assembly comprises an internet protocol web camera.

12. The trapping system of claim 11, wherein the internet protocol web camera transmits the wireless detection signal to the display device via a wireless internet network.

13. The trapping system of claim 12, wherein the display device comprises a computer.

14. The trapping system of claim 1, wherein the display device transmits the wireless control signal to the control mechanism in response to manual activation of the display device by an operator of the display device.

15. The trapping system of claim 14, wherein in the closed position, the enclosure cooperates with a ground surface to define an enclosure area in which the at least one wild animal is trapped, and wherein the enclosure comprises an enclosed surface area of at least 100 square feet.

16. A trapping system for capturing a plurality of feral pigs, comprising:

an enclosure having at least one portion that is movable between an open position that permits passage of a plurality of feral pigs into the enclosure and a closed position that restricts passage of the plurality of feral pigs out of the enclosure, wherein in the closed position, the enclosure cooperates with a ground surface to define an enclosure area in which the plurality of feral pigs are trapped;

a camera assembly configured to transmit a wireless detection signal;

a display device in communication with the camera assembly and configured to: receive the wireless detection signal from the camera assembly, and

transmit a wireless control signal upon receipt of the wireless detection signal from the camera assembly;

a control mechanism in communication with the display device and configured to receive the wireless control signal from the display device, wherein the wireless control signal corresponds to an instruction to the control mechanism to generate a release signal;

a release mechanism in communication with the control mechanism and configured to effect movement of the at least one portion of the enclosure from the open position to the closed position upon receipt of the release signal from the control mechanism,

wherein, upon detection of a presence of the plurality of feral pigs within the enclosure by the camera assembly, the camera assembly transmits the wireless detection signal to the display device.

17. The trapping system of claim 16, wherein the enclosure comprises an enclosed surface area of at least 100 square feet, wherein in the open position, the enclosure permits passage of the plurality of feral pigs into the enclosure through an open space having a width of at least three feet, wherein in the open position, the at least one portion of the enclosure is spaced vertically from a ground surface, wherein in the closed position, the enclosure cooperates with the ground surface to define an enclosure area in

which the plurality of feral pigs are trapped, and wherein the ground surface extends continuously from within the enclosure area to areas surrounding the enclosure.

18. The trapping system of claim 16, wherein the camera assembly transmits an image of the plurality of detected feral pigs within the enclosure to the display device.

19. The trapping system of claim 16, wherein the camera assembly comprises an internet protocol web camera, and wherein the internet protocol web camera transmits the wireless detection signal to the display device via a wireless network.

20. A trapping system for capturing at least one wild animal, comprising:

an enclosure having at least one portion that is movable between an open position that permits passage of at least one wild animal into the enclosure and a closed position that restricts passage of the at least one wild animal out of the enclosure;

a camera assembly configured to transmit a wireless detection signal upon detection of a presence of the at least one animal within the enclosure by the camera assembly;

a display device in communication with the camera assembly and configured to:

receive the wireless detection signal from the camera assembly, and

transmit a wireless control signal upon receipt of the wireless detection signal from the camera assembly;

a control mechanism in communication with the display device and configured to receive the wireless control signal from the display device, wherein the wireless control signal corresponds to an instruction to the control mechanism to generate a release signal;

a release mechanism in communication with the control mechanism and configured to effect movement of the at least one portion of the enclosure from the open position to the closed position in response to receipt of the release signal from the control mechanism;

a relay in operative communication with the control mechanism;

a solenoid positioned in operative communication with the relay and operatively coupled to the release mechanism; and

a battery in operative communication with the relay and the control mechanism,

wherein in response to receipt of the wireless control signal from the display device, the control mechanism is configured to send the release signal to the relay, the relay is configured to trigger the battery to send a direct current output to the solenoid, and the solenoid is configured to trigger the release mechanism to move the at least one portion of the enclosure to the closed position.

* * * * *